



Comhairle Chontae Chill Chainnigh

Halla an Chontae Sraid Eoin Cill Chainnigh
R95 A39T

Pobail agus Áiteanna Inbhuanaithe a Chruthú

Kilkenny County Council

County Hall John Street Kilkenny
R95 A39T

Creating Sustainable Communities and Places



Date: 3rd April, 2023

Our ref: D28/691/B

**TO: THE CATHAOIRLEACH
AND EACH MEMBER OF KILKENNY COUNTY COUNCIL**

**RE: DISPOSAL OF INTEREST IN LAND AT CONEYKEARE, LEIGHLINBRIDGE, CO.
CARLOW**

A Chara,

Notice is hereby given, that at a meeting of the Council to be held after the expiration of 10 days from the date of this notice, it is the intention of Kilkenny County Council, in accordance with Section 183 of the Local Government Act, 2001, to dispose of its interest in land at Coneykeare, Leighlinbridge, Co. Carlow – as identified on the attached map - to John Kelly, Seskin Lower, Leighlinbridge, Co. Carlow for the nominal sum of €10 (ten euro) and each party will be responsible for their own legal costs associated with the sale. Area combined measures 0.16 acre. The Consent of the Minister for Housing, Local Government and Heritage is not required.

BACKGROUND

This surplus land was acquired for provision of a farm underpass but was ultimately not required and is now fenced off within Mr. Kelly's field.

Mise, le meas,

Martin Prendiville

Martin Prendiville
Head of Finance

Location Plan

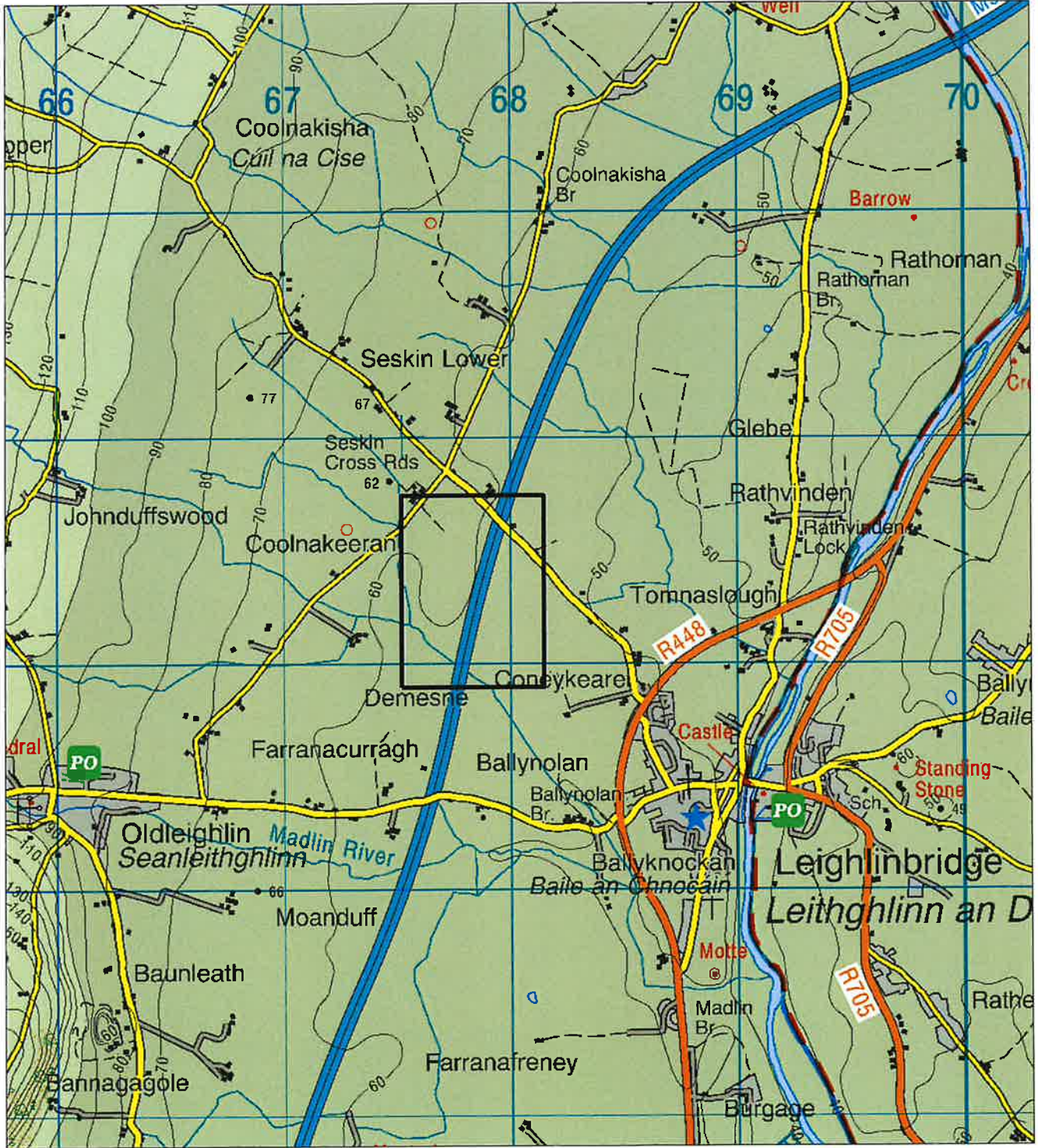

Land at Coneykeare, Leighlinbridge,
Co Carlow

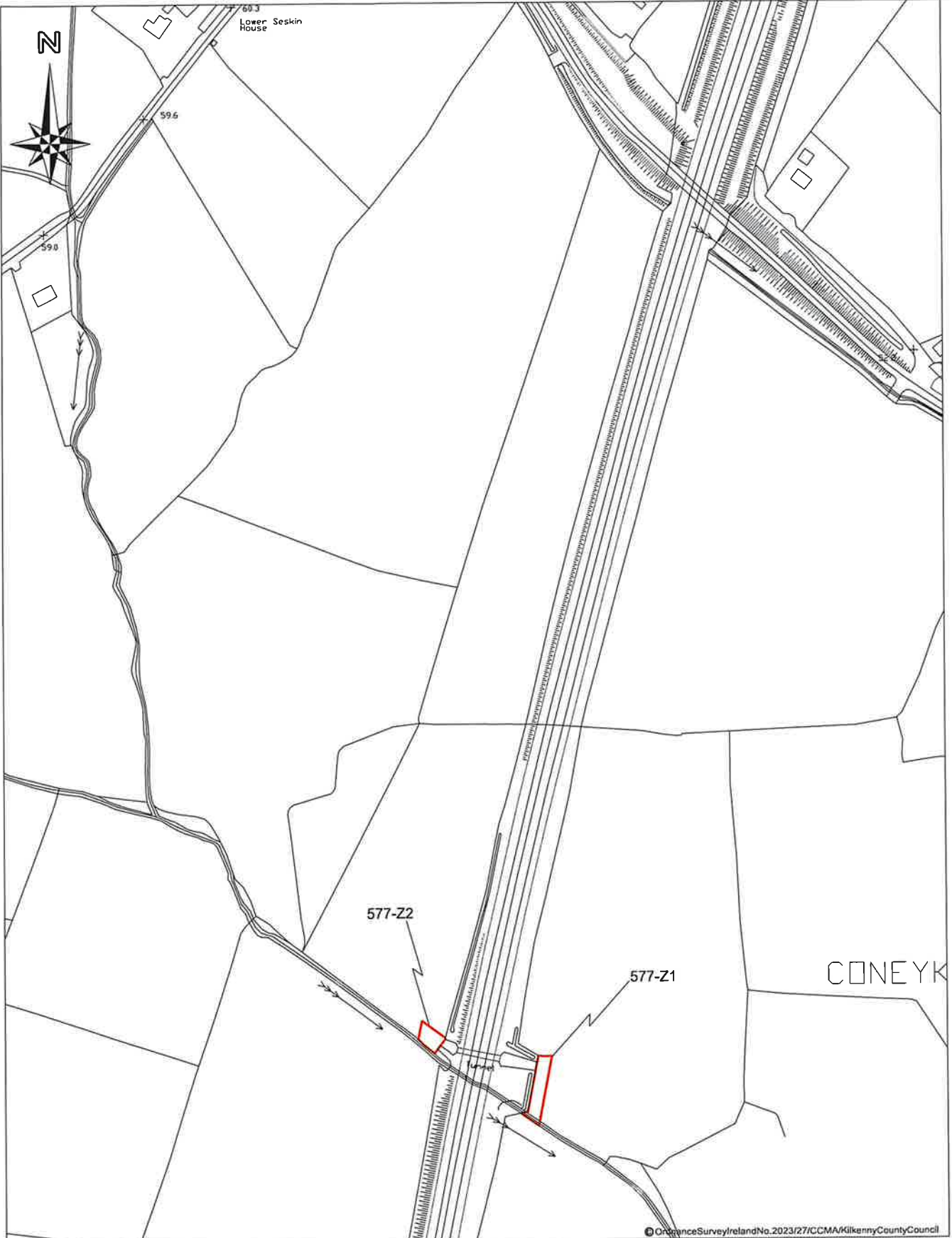

© Ordnance Survey Ireland No. 2023/27/CCMA/Kilkenny County Council

E667393.993
N665908.935

Plot	Area (ha)	Land	Townland	Folio	Owner
577-Z1	0.0440	Field	Coneykeare	CW30650F	Kilkenny County Council
577-Z2	0.0226	Field	Coneykeare	CW30650F	Kilkenny County Council

0.0666 ha (0.16 acres)



KILKENNY COUNTY COUNCIL
Comhairle Chontae Chill Chainnigh
ROAD DESIGN SECTION,
1 DEAN STREET
KILKENNY.

Rev	By	D/W	Description

Project: M9 Motorway		File Name:		Drawing No.	
Component:		Scale:		M9-CPO/577-1A	
Title: Land at Coneykeare		Date:		18th Jan 2023	
Designed By: AM	Checked By: AM	Scale:	1:2500 (@ A3)		